

BED FOOTBOARD PANEL

Assembly Instructions
For all sizes

1011

1 Parts in this Box.



Panel x 1

2 Hardware in this Box.



Metal Plate
x 2

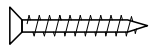

16mm Wood Screws
x 8

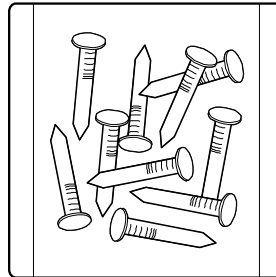

Bag of Small Nails (8pc)

Note: There are enough nails for the King Size Panel, so you may have some left over.

3 Assembly

STEP 1

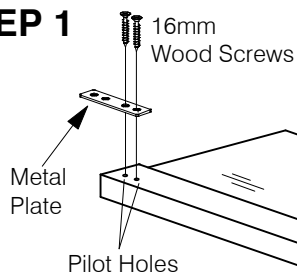

STEP 2

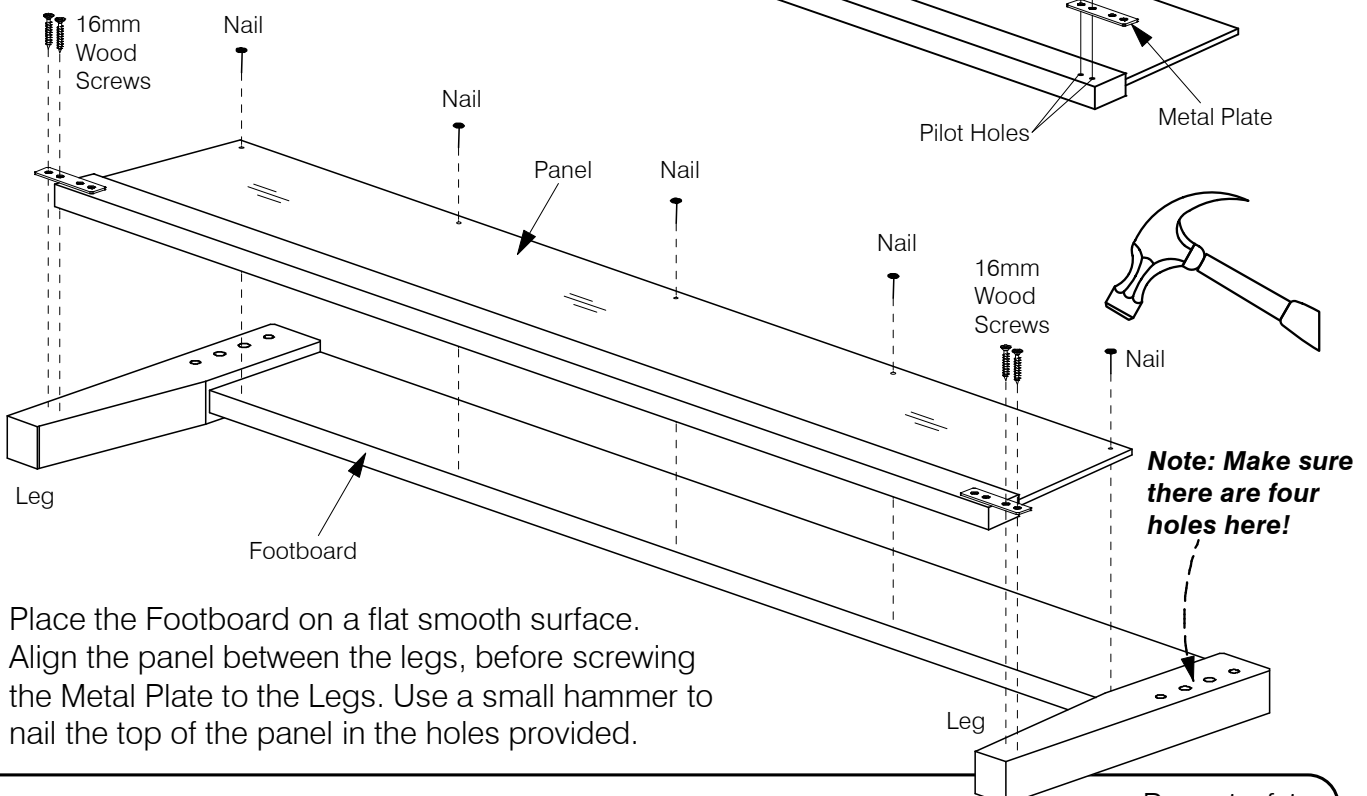

Place the Footboard on a flat smooth surface. Align the panel between the legs, before screwing the Metal Plate to the Legs. Use a small hammer to nail the top of the panel in the holes provided.